



User manual of COSMO | WT9 controller.

1. GENERAL INFORMATION



COSMO | WT9 is a 9-channel remote controller for wall mounting, designed for remote control receivers brand **MOBILUS** (radio remote controls for roller shutters, awnings, blinds / control modules for motors without radio communication module / ON / OFF modules).

- Support 9 channels.
- Support 99 channel groups.
- Bi-directional communication - the opportunity to receive additional feedback information from receivers.

Remote **COSMO | WT9** - a remote control with touch screen keyboard. It has the ability to control with the motions.

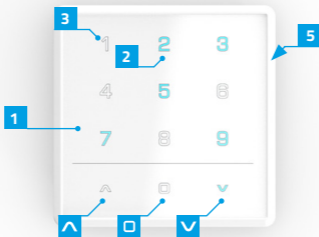
2. DESCRIPTION OF THE REMOTE CONTROL



- 1 The touch screen of remote control **COSMO | WT9**.
 - 2 The selected channel - highlighted in blue.
 - 3 Not selected channel - highlighted in white.
 - 4 Battery compartment 2 x AAA.
 - 5 The upper, main housing of remote **COSMO | WT9**
 - 6 The rear housing flap mounted to the wall.
-  Control button / navigation area - **UP**.
 Control button / navigation area - **DOWN**.
 Control button / navigation area - **STOP**.
P1 Function button 1.
P2 Function button 2.

CONTINUED 2. DESCRIPTION OF THE REMOTE CONTROL

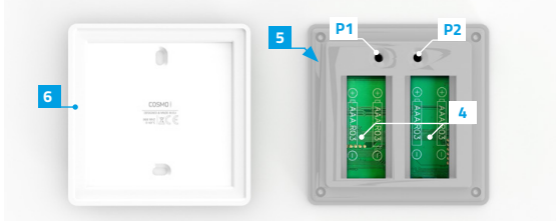

3. CONTENTS OF THE PACKAGE

The packaging contains the following items:

- remote **COSMO | WT9**
- 4 AAA batteries in the remote control protected against discharging with a seal,
- user manual,
- fixing pins (2 pcs.).

4. TECHNICAL PARAMETERS

- Radio protocol: COSMO
- Frequency: 868 [MHz]
- Dynamic code
- FSK modulation
- The supply voltage 3,0 V DC 
- Power source: batteries 4 x AAA LR03.
- Working temperature [°C]: 0-40°C.
- Display: touch screen with illuminated fields.
- Range in building: 40 [m]. The range of the radio signal depends on the type of construction, used materials and placement of units. The transmission of the radio signal in different conditions is as follows: brick wall 60-90%, reinforced concrete 2,060%, wooden structures with sheets of plasterboard 80-95%, glass 80-90%, metal walls 0-10%.
- Buzzer - tone generator.
- Dimensions: 80 x 80 x 20 mm.

5. ASSEMBLY OF A HOLDING FIXTURE

Elements of wall handle:

- rear housing of remote - **A**,
 - anchors with screws - **B**.
1. Determine the position where the rear flap of housing will be located (easy access, no running power cables, pipes, reinforcement of walls, etc.).
 2. Determine the points on the wall so that the rear housing after assembly will adhere to the wall and will be mounted perpendicular to the ground.
 3. Drill the holes and place the assembly anchors (distance between the holes 36 mm, diameter 3.5 mm).
 4. Attach the handle and tighten it to the wall.
 5. Place front housing of the remote control to screwed flip.

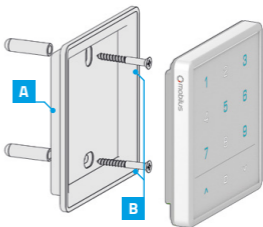

6. POWER SUPPLY

The device is powered by four batteries **AAA LR03**.

In order to change the battery, disconnect the upper housing remote from parts mounted on the wall.

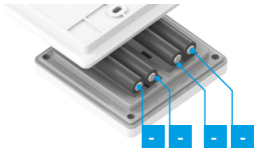

7. THE INITIAL COMMISSIONING

The device is factory protected against battery wearing. To the deprotection:

1. Open the battery cover.
2. Remove the seal **Z**, which protects the batteries from discharging (marked in white).

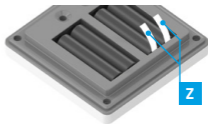

8. WT9 REMOTE CONTROL OPERATION | MOTIONS

Remote control **COSMO | WT9** allows the user two control modes.

Mode 1 - touch - the user selects the channels and issue commands by touching with his finger on the remote's screen. Waking up the remote control followed by touching the screen of remote control.

Mode 2 - touch with full support for motions - you wake up the remote through both by waving your hand to the screen of remote control (a distance of about 10 cm) and by the touch. You issue commands by touching the screen with your finger on the screen of remote control and the corresponding movement of the hand in front of remote control.

To select a mode, press the **P2** button located under the battery cover - Fig. 8a. Activation of the next mode is confirmed by lighting up of all control LEDs:

Mode 1 - light up control keys on red - Fig. 8b.

Mode 2 - light up control keys on blue - Fig. 8c.

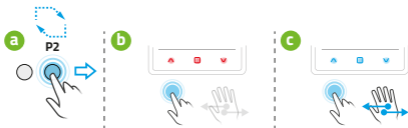
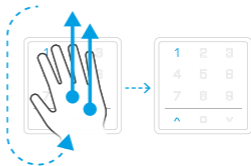

Fig. 8

1. In order to control the channel, activate the screen by waving your hand at a distance of about **10 cm**. The screen is activated. Last-controlled channel is highlighted in blue. We change it by touching the area of the desired channel.

2. Command **ON / UP** - you need to make a movement with your hand from the bottom up in front of the motor. The display lights up control field on blue color **▲**.

WARNING! *The return movement of the hand should be performed outside the remote control. Otherwise, the command OFF / DOWN will be activated.*



CONTINUED 8. WT9 REMOTE CONTROL OPERATION | MOTIONS

3. Command **OFF / DOWN** - you need to make a movement with your hand in the direction from up to down in front of the motor. The display lights up the control field on blue color .

WARNING! *The return movement of the hand should be performed outside the remote control. Otherwise, the command ON / UP will be activated.*

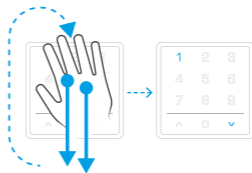

4. STOP command - you need to make a movement with your hand from left to right in front of the remote control (or vice versa). The display lights up control field on blue color .

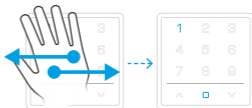

9. WT9 REMOTE CONTROL OPERATION | ACTIVATING THE DISPLAY

Remote control **COSMO | WT9** in order to save energy introduces a screen in stand-by mode. Its re-activation can be done in three ways:

1. Activation by the touch your finger in a numeric field. In this mode the channel is activated, which has been touched. The remote is expected to order for the selected channel or selection of another channel - Fig. 9.1.

NOTE *If a lot of channels is highlighted by working with remote control and you want to control only one, keep the channel longer. The rest will be dimmed, only the selected channel will be highlighted.*

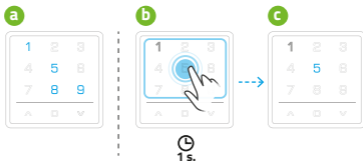

Fig. 9.1

CONTINUED 9. WT9 REMOTE CONTROL OPERATION | ACTIVATING THE DISPLAY

2. Activation by touch with a finger on the control buttons. In this mode, the channels will be activated on the display that have been managed in the last session before going to stand-by. The remote control is expected to order for these channels or select more channels - Fig. 9.2.

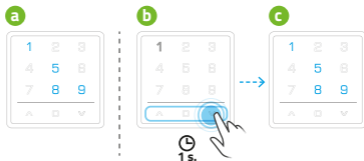

Fig. 9.2

3. Activation by waving your hand to the field on the remote control screen. This mode is only possible with the active control motions. In this mode, the channels will be activated on the display that have been managed in the last session before going to stand-by. The remote control is expected to order for these channels or select more channels - Fig. 9.3.

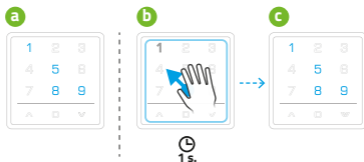

Fig. 9.3

10. READING OF REMOTE INTO THE MOTOR'S MEMORY

WARNING! Do not program the remote control when the shutter is in the extreme position (top or bottom). Each program and changes of motor's operation directions are confirmed by two micro-movements of the driver.

Failure to comply with these rules may result in damage the blinds (inhaled by the housing).

WARNING! Operation: **LOADING THE REMOTE CONTROL INTO MOTOR'S MEMORY** is only possible in the **MODE 1** of remote control (motions control is off).

CONTINUED 10. READING OF REMOTE INTO THE MOTOR'S MEMORY

1. Activate the screen with your finger touching on the surface of the field for about 1 sec. and select the channel (only one) you want to program for the receiver - Fig. 10.1.
2. Enter **MOBILUS motor, serie R** in the PROGRAMMING MODE OF MASTER REMOTE:
 - press for 5 seconds **PROGRAMMING BUTTON** in the motor - Fig. 10.2a;
 - or double turn off and turn on the power supply of the motor - Fig. 10.2b;



Fig. 10.1

The confirmation of properly performed operation will be two micro-movements of the motor driver - Fig. 10.2c.

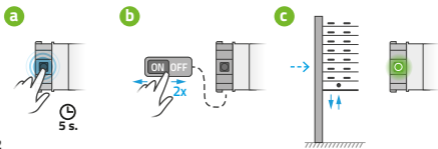

Fig. 10.2

WARNING! The first remote control readed into the receiver is a remote control **MASTER**. It allows you to operate motor and enter it in the **PROGRAM MODE OF OTHER REMOTES**.

3. On the remote control simultaneously press the **□** and **▲** - Fig. 10.3a. LED start blinking - Fig. 10.3b. Hold the buttons until the motor driver will perform two micro-movements. The remote control has been readed into the motor.

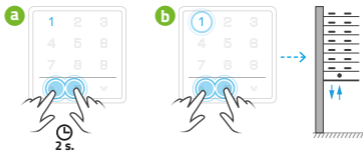



Fig. 10.3

11. READING IN OTHER REMOTE

WARNING! Operation: **READING THE NEXT REMOTE CONTROL** is only possible in the **MODE 1** of remote control (motions control is off).

CONTINUED 11. READING IN OTHER REMOTE

1. On the **MASTER** remote control simultaneously press the  and  - Fig. 11.1a. The control LEDs and LED of the selected channel start flashing. Hold the buttons until the motor driver will perform two micro-movements confirming the input of the motor in the PROGRAM MODE. - Fig. 11.1b.

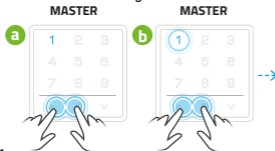

Fig. 11.1

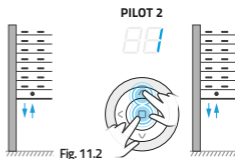

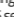

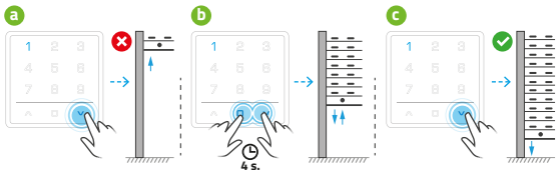

Fig. 11.2

2. On the second remote control, you want to program, press the  and . Hold the buttons until the motor driver will perform two micro-movements - Fig. 11.2. Another remote was loaded into the motor.

Within 20 sec. you can proceed to load the next remote. However, if no action of programming at this time doesn't happen, motor automatically returns to the OPERATING MODE. You can expedite return to the OPERATING MODE manually using the remote control MASTER. In this case, press the button on the  and  and hold more than 5 seconds. In both cases, return to the OPERATING MODE will be confirmed by two micro-movements of the driver.

12. CHANGE OF MOTOR'S OPERATION DIRECTION



After loading the remote control to the motor check that the buttons **UP** and **DOWN** correspond to lifting and lowering the blinds. If not, press simultaneously buttons **STOP** and **DOWN** and hold them for about 4 seconds on the remote control any loaded to the motor. The confirmation of correctly performed operation are two micro-movements of the driver.

CONTINUED 12. CHANGE OF MOTOR'S OPERATION DIRECTION

WARNING! You can change the direction of the work of motor for MOBILUS drives with electronic limit switches only before setting the upper and lower limit switches. You can change the direction of work for the MOBILUS motors with mechanical limit switches at any time.

WARNING! Operation: CHANGING THE DIRECTION OF MOTOR'S OPERATION is only possible in the remote control MODE 1 (control motions are off).

13. BI-DIRECTIONAL COMMUNICATION

Remote control **COSMO | WT9** enables bi-directional exchange of information with the receiver / receivers (sends and receive messages).

This feature allows you to control the state of blinds, check whether they have been properly lowered or raised as to whether there is damage to be checked (eg. due to interference by third parties).

Correct functioning of bidirectional communication requires:

- use of the receivers with bidirectional communication,
- programming one channel only for one receiver,
- the correct channel configuration - setting for bidirectional communication channel,
- ensure seamless communication of the remote control with the receiver.

Receivers supporting the bidirectional communication: **MOBILUS: M35 ERS, M45 ERS.**

In the case where the performed operation remote **COSMO | WT9** receives from the receiver the error message (eg. the casing lock) the control keys light up red and the channel with the error will be highlighted. Due to the battery consumption time of waiting for feedback has been limited to 20 seconds.



14. TRANSMISSION PROTOCOL SWITCHING COSMO - COSMO | 2WAY

Remote control **COSMO | WT9** works in latest version of radio communication **COSMO | 2WAY**. If you need to change the mode to an older version (for example, if you purchase a new remote control for older COSMO radio tubular motors), follow these instructions:

1. Activate the remote control.
2. Press and hold the **P1 + P2** function buttons on the back of the controller for 20 seconds at the same time. - Fig. 14.
3. When the LEDs at the bottom of the front panel light up, the corresponding communication standard is activated:

colour red - the latest radio communication **COSMO | 2WAY**

blue colour - previous communication **COSMO**

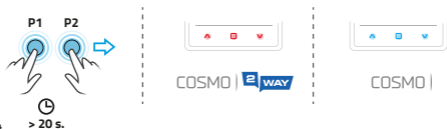

Fig. 14 > 20 s.

15. CHECK THE ACTIVE COMMUNICATION MODE

To quickly identify the active communication mode:

1. Activate the remote control.
2. Press and hold the **STOP** button for about 5 seconds - Fig. 15.
3. The LEDs in the lower part of the front panel shall light up indicating:
colour red - the latest radio communication **COSMO | 2WAY**
blue colour - previous communication **COSMO**

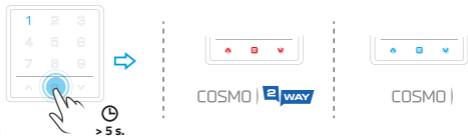

Fig. 15 > 5 s.

16. THE BEEPS - ACTIVATION / DISACTIVATION

You can turn on / off beeps in the remote **COSMO | WT9**. To do this, press and hold button **P1** located under the battery cover. At the same time pull out the battery, so as to deprive remote power source, and then put it again in the remote control. If the remote will beep at this time - beeps are active. If there is the silence - beeps have been turned off.

17. WARRANTY

The manufacturer guarantees correct device functioning. The manufacturer also agree to repair or replace device damaged if the damage results from defects in materials and construction.

The warranty is valid for 24 months from the date of purchase under the following conditions:

- Installation was made by a person authorized in accordance with the manufacturer's instructions
- Seals haven't been breached and unauthorized design changes haven't been made.

CONTINUES 17. WARRANTY

- The device was operated as intended by the user manual.
- Damage is not a result of the improperly performed electrical installation or any atmospheric phenomena.
- The manufacturer is not responsible for damage resulting from misuse or mechanical damage.
- In case of failure the device should be provided for repair with proof of purchase.

Defects found during the warranty period will be removed free for no longer than 14 working days from the date of acceptance of device for repair. The manufacturer MOBILUS MOTOR Sp. z o.o. carries on warranty repairs. If you have any questions, please contact your dealer (please provide the following information: event description, description of the error, the conditions under which the accident occurred).

18. MAINTENANCE

1. For cleaning, use a soft cloth (eg. microfiber), moistened with water. Then wipe dry.
2. Do not use chemicals.
3. Avoid using in soiled and dusty environments.
4. Do not use the device at temperatures higher or lower than the declared range.
5. Do not open the device - otherwise the warranty shall be lost.
6. The device is sensitive to dropping, throwing.

19. REPAIR

If you have any questions, please contact your dealer. Please provide the following information: event description, description of the error, the conditions under which the accident occurred.

20. ENVIRONMENTAL PROTECTION



This appliance is marked according to the European Directive on Waste Electrical and Electronic Equipment (2002/96/EC) and further amendments. By ensuring this product is disposed of correctly, you will help to prevent potential negative consequences for the environment and human health, which could otherwise be caused by inappropriate waste handling of this product. The symbol on the product, or the documents accompanying the product, indicates that this appliance may not be treated as household waste. It shall be handed over to the applicable collection point for the waste electrical and electronic equipment for recycling purpose. For more information about recycling of this product, please contact your local authorities, your household waste disposal service or the shop where you purchased the product.

MOBILUS MOTOR Spółka z o.o.

ul. Miętowa 37, 61-680 Poznań, PL

tel. +48 61 825 81 11, fax +48 61 825 80 52

VAT NO. PL9721078008

www.mobilus.pl

Version 1.0ENG, 170619